

8X M4X0.7 ∇ .375"
AS SHOWN FOR MOUNTING

[22.2mm]
 ϕ .875in
MAX. INPUT C.A.

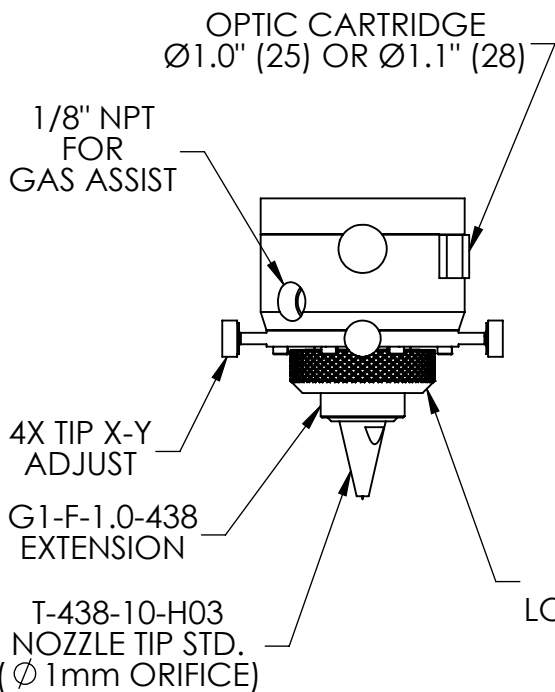
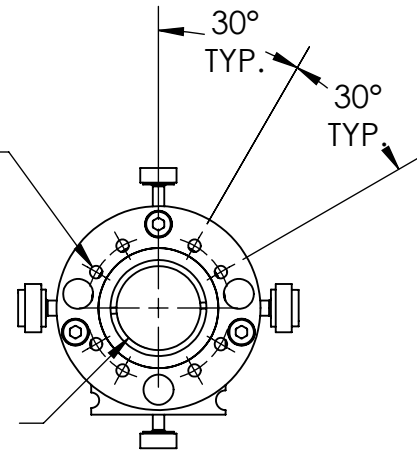

2X OPTIC CARTRIDGE
LOCK THUMB SCREW

NOZZLE TIP
ADJUST Z
LOCK COLLAR

.039 [1mm]
TIP STAND-OFF

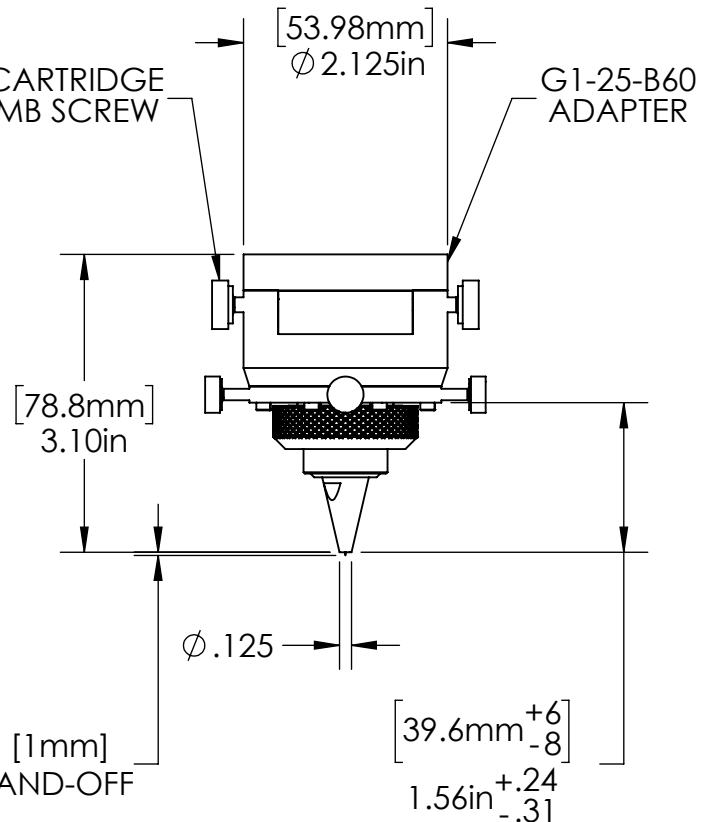

FOR INFORMATION ONLY
NOT FOR MANUFACTURING

DATE:
02/04/09

DRAWN BY:
RS

CHK'D BY:
GJH

TOLERANCES:
(EXCEPT AS NOTED)
X.XXX = ± 0.005
X.XX = ± 0.01
X X/X = $\pm 1/64$
ANGULAR: $\pm 0.5^\circ$



37 IRONIA ROAD
FLANDERS NJ 07836
(973) 598-1150
Fax: 598-1151

HAAS DOCUMENT# G1-25-25-064-SALES

SPECIFICATION SUBJECT TO CHANGE WITHOUT NOTICE.
CONTACT HAAS LTI FOR MORE INFORMATION.

G1 HEAD LAYOUT 2.5 EFL.
G1-25-25-064 & G1-25-28-064

BOM#
NA

SCALE: 1:1/A