

OUTPUT

$\phi 1.375\text{in}$
[34.93mm]
C.A.

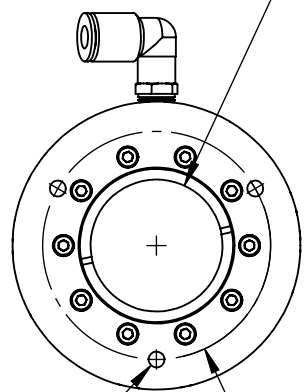

$\phi 2.375\text{in}$
[60.33mm]

3X M5X0.8 ∇ .394in [10mm]

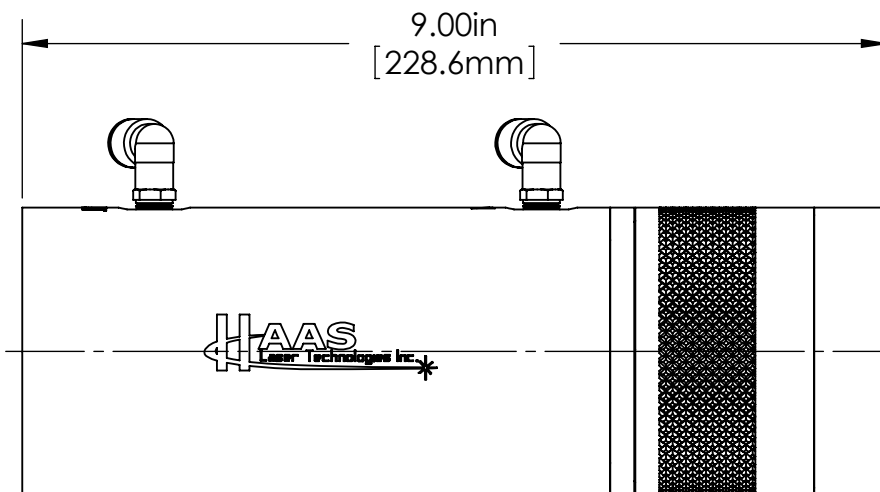

FOCUS CONTROL

INPUT

$\phi .940\text{in}$
[23.88mm]
C.A.

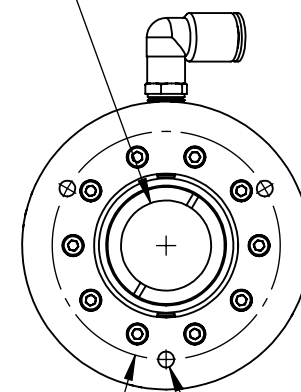

$\phi 2.375\text{in}$
[60.33mm]

3X M5X0.8 ∇ .394in [10mm]

FOR INFORMATION ONLY
NOT FOR MANUFACTURING

DATE:
3/3/2017

DRAWN BY:
MPM

CHK'D BY:
RS

TOLERANCES:
(EXCEPT AS NOTED)

X.XXX = ± 0.005

X.XX = ± 0.01

X X/X = $\pm 1/64$

ANGULAR: $\pm 0.5^\circ$

NO.

REVISIONS

DATE

APPD

HAAS DOC.# BEC-38-5.0-10.6-W-SALES

SPECIFICATIONS SUBJECT TO CHANGE WITHOUT
NOTICE. CONTACT HAAS LTI FOR MORE INFORMATION.



37 IRONIA ROAD
FLANDERS NJ 07836
(973) 598-1150
Fax: 598-1151

BEC-38-5.0-10.6-W WATER COOLED
CUSTOMER DIMENSIONAL INFO

BOM#
NA

SCALE: 1:2